



Tasman Walk, West Beckton, E16

BUTLER & STAG



Recently redecorated four bedroom family home offering spacious living throughout located within a short walking from Prince Regent DLR.



- Four Bedrooms
- Private Garden
- Available NOW
- Semi Detached
- Recently Redecorated
- Prince Regent DLR

Internally, the property offers two reception rooms, fitted kitchen and downstairs cloakroom. On the first floor there are four bedrooms, family bathroom and additional shower room.

Externally the property benefits from a private rear garden.

The property is situated within a short walking distance of local shops, Schools, Churches and only 25 minutes commute from central London.

The property is available NOW on an unfurnished basis.





Tasman Walk, E16

First Floor

Approx. 59 Sq. meters (635 Sq. feet)

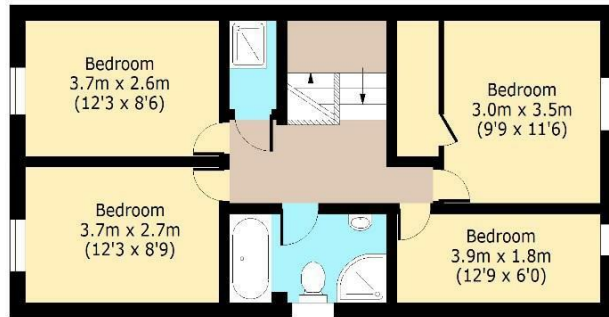

Ground Floor

Approx. 59 Sq. meters (635 Sq. feet)

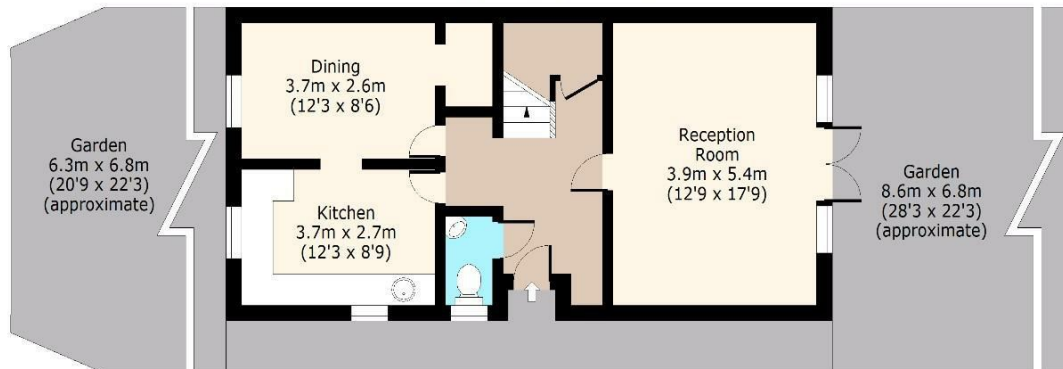

Total area: approx. 118 Sq. meters (1270 Sq. feet)
For illustration purposes only - not to scale
www.lpaplus.com



BUTLER & STAG

☎ 020 8102 1236

🏠 508 Roman Road, Bow, London, E3 5LU

✉ bow@butlerandstag.com

www.butlerandstag.uk

IMPORTANT NOTICE - These particulars have been prepared in good faith and they are not intended to constitute part of an offer or contract. We have not performed a structural survey on this property and the services, appliances and specific fittings have not been tested. All photographs, measurements, floor plans and distances referred to are given as a guide and should not be relied upon.